

- 1 - NON-BREATHABLE MEMBRANE
- 2 - ROOF INSULATION (CELOTEX OR SIMILAR)
- 3 - VENTILATION GAP
- 4 - BREATHABLE MEMBRANE
- 5 - ROOFING BATTEN
- 6 - CROSS BATTEN WITH VENTILATION GAP
- 7 - ROOFING TILE
- 8 - VENTILATION GAP WITH MESH
- 9 - KREISEL SYSTEM

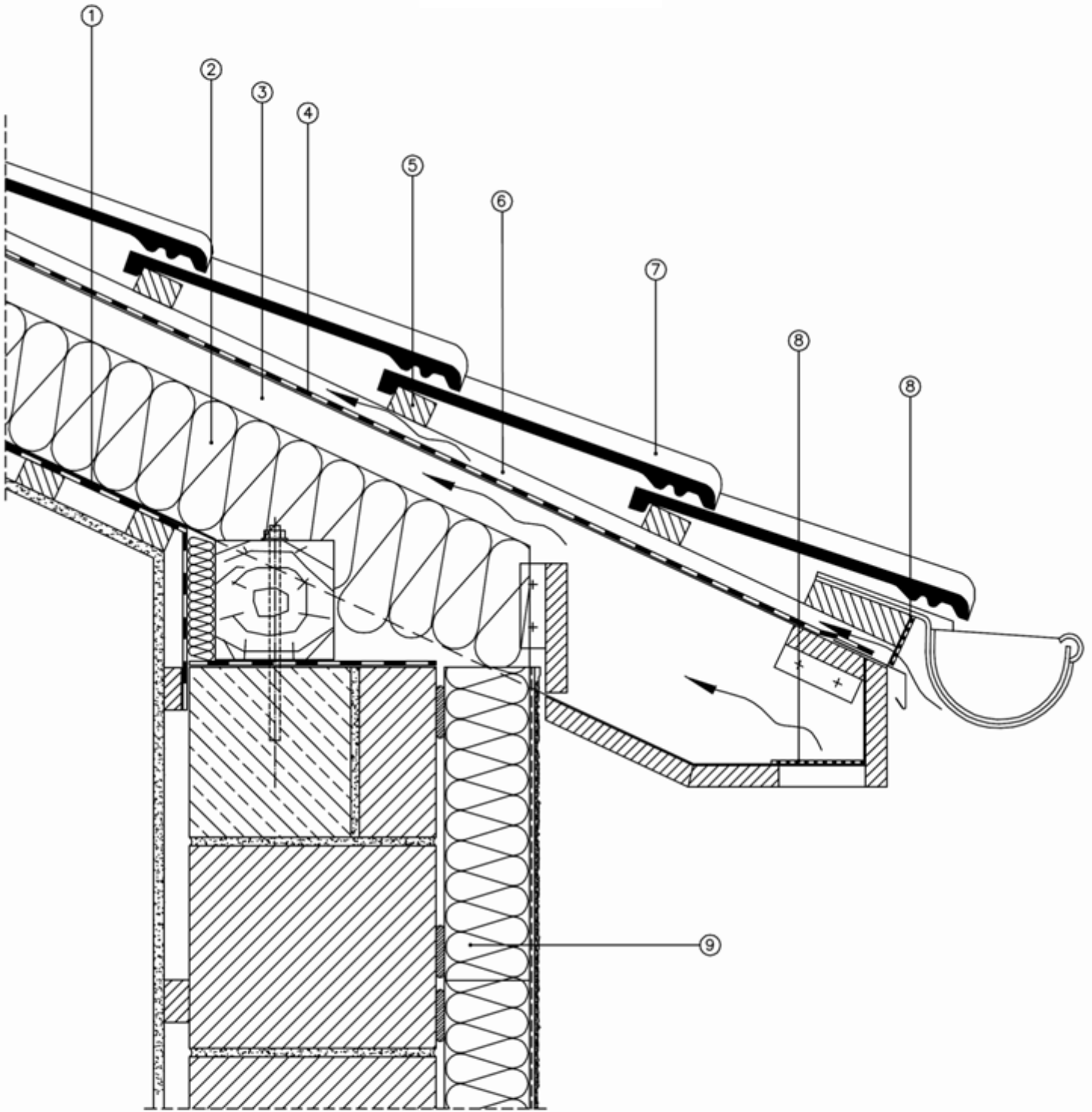

**KREISEL**



**MODERN.INSULATION.SYSTEMS**